

BARSTOOL
HEIGHT: 34"
ADJUSTABLE HEIGHT
TO 73 3/4"

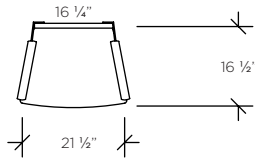

ARMCHAIR
HEIGHT: 34 1/4"

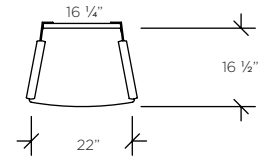

SWIVEL DESK CHAIR
HEIGHT: 32 1/2"
ADJUSTABLE HEIGHT
TO 36 1/4"



Chrome and leather mingle gracefully around the frame of the Circa Collection. The same aesthetic can be found in a dining chair, barstool and complimentary desk chair.

Villency Contract furniture is designed to be adaptable to the specific needs of your project. Each piece from our collection can be customized to fit your exact specifications and budget, no matter what the quantity. Our striking design and attention to detail, combined with our environmental promise and commitment to excellence, is unparalleled in the hospitality and contract world.

IF YOU CAN ENVISION IT, WE CAN BUILD IT.

Marie Villency
VILLENCY CONTRACT